

**A06**

Square Design A06

- Two- to Four-Finger Hollow Gripper -

Characteristics:

- centric, linear and parallel or swiveling finger movement, can also be combined
- adjustable in finger length, amount and position.
- inside and outside gripper
- lubrication and maintenance free slide bearings
- constant hollow tube (Ø38mm)
- self-locking free
- stepless stroke adjustment with shock absorbing action
- multiple position monitoring through proximity switch, optional

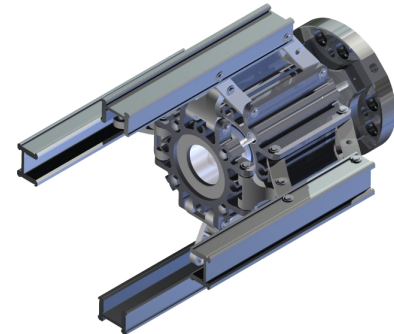

Illustration: type A106-400100-A-PNO-00

Technical Data							
Type A06			Finger Length (F)				
			0 mm	40 mm	60 mm	80 mm	100 mm
Finger Movement A (parallel open / parallel close)	Stroke [mm]		53				
	Gripping Width* [mm]		192 to 245				
	Gripping Force*** [N]		692 to 4.652				
Finger Movement B** (parallel open / swiveling close)	Stroke [mm]		57	75	83	92	101
	Gripping Width* [mm]		188 to 245	170 to 245	162 to 245	153 to 245	144 to 245
	Gripping Force*** [N]		669 to 4.158	543 to 2.421	496 to 2.003	457 to 1.708	423 to 1.489
Finger Movement C** (swiveling open / swiveling close)	stroke [mm]		59	91	106	124	139
	Gripping Width* [mm]		189 to 248	177 to 268	171 to 277	164 to 288	158 to 297
	Gripping Force*** [N]		657 to 4.030	498 to 1.517	445 to 1.156	401 to 934	366 to 784
Drive			pneumatic				
Operating Air Pressure			2 to 6 bar				
Cycle Time (undamped)			0,5 s				
Energy Consumption per Cycle			0,95 liter (at 6 bar)				
Operating Temperature			-30 to +80°C				
Mass	Operating Unit		1,8 kg				
	per Finger Mechanism		max. 285 g				
Loading Capacity* per Finger with Gripping Mass and Acceleration	Mx _{max.}		5,5 Nm ⇒ (Fy _{max.} : 55 N at finger length F = 100mm)				
	My _{max.}		11 Nm ⇒ (Fx _{max.} : 110 N at finger length F = 100mm)				
	Mz _{max.}		8 Nm				
	Fz _{max.}		250 N				

* referring to fingers' outer edge
 ** larger strokes through adjustment of gripping width and pivoting angle on request
 *** higher gripping force always at finger position "open" (data referring to 6 bar air pressure)

* loading capacity autonomous of gripping force



address:
 GMG – Gesellschaft für modulare Greifersysteme mbH
 Rödingerweg 8H
 D-59494 Soest
 Germany

phone:
 +49 (0)2921 – 4062
fax:
 +49 (0)2921 - 4042

e-mail:
 info@gmg-system.com
homepage:
 http://www.gmg-system.com



A06

Quantity and Position of Fingers

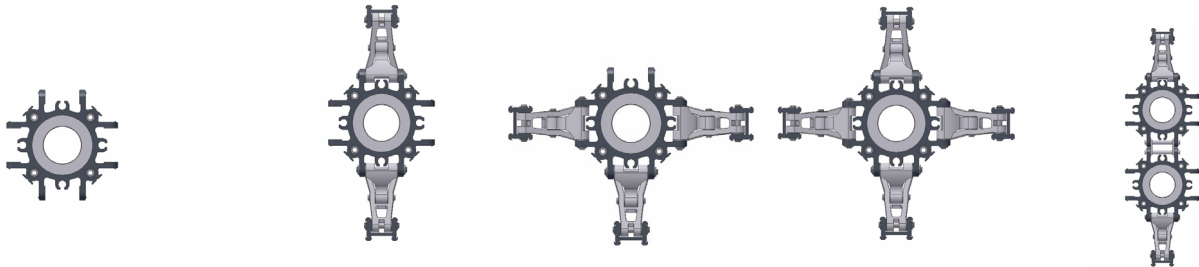

Basic Shape A06

A106-200

A106-300

A106-400

A206-200

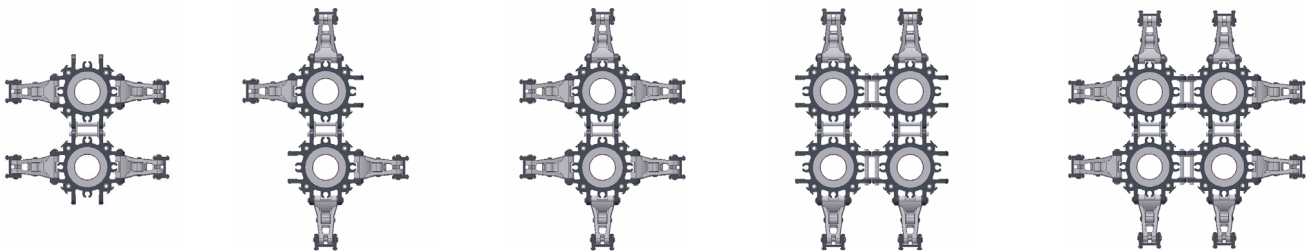

A206-400

A206-410

A206-600

A406-400

A406-800

Finger Movement

Shape A

(parallel open / parallel close)

Shape B

(parallel open / swiveling close)

Shape C

(swiveling open / swiveling close)

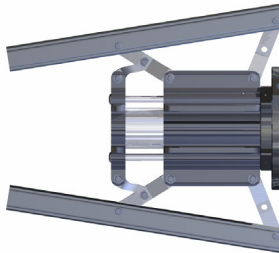
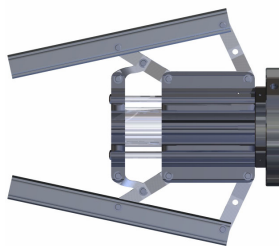
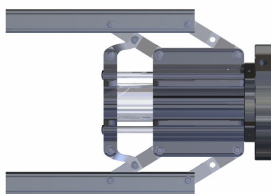
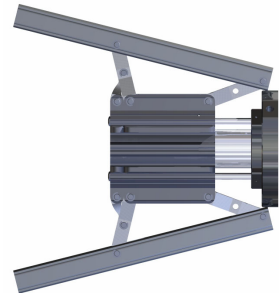
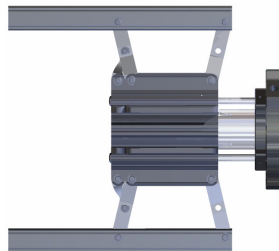
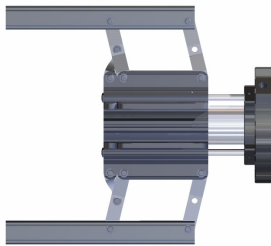

Special Movement through combining shapes are possible upon request!



address:

GMG – Gesellschaft für modulare Greifersysteme mbH
Rodingerweg 8H
D-59494 Soest
Germany

phone:

+49 (0)2921 – 4062

fax:

+49 (0)2921 - 4042

e-mail:

info@gmg-system.com

homepage:

http://www.gmg-system.com



A06

Finger Movement A

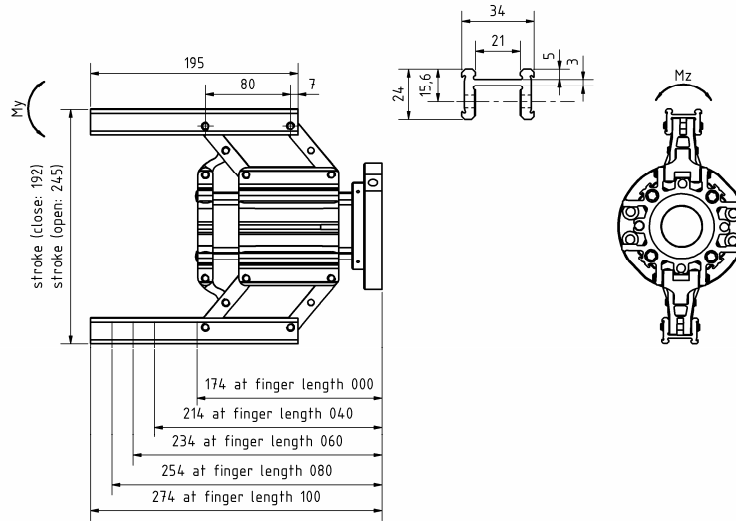

Finger Movement B

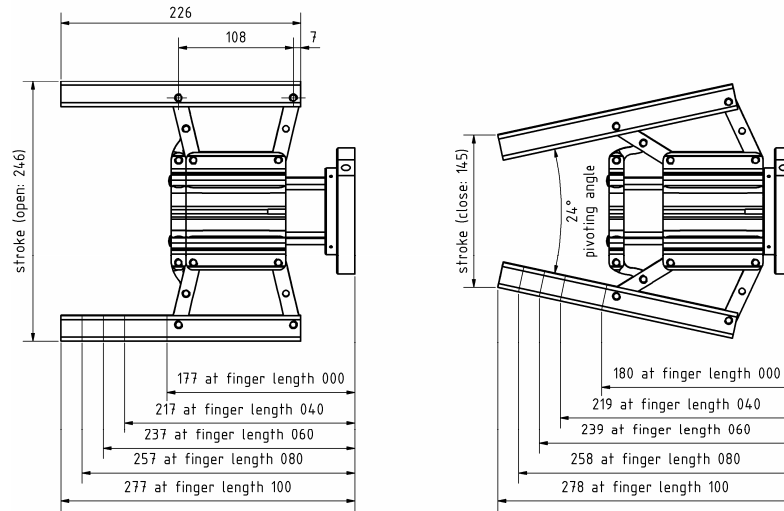

Finger Movement C

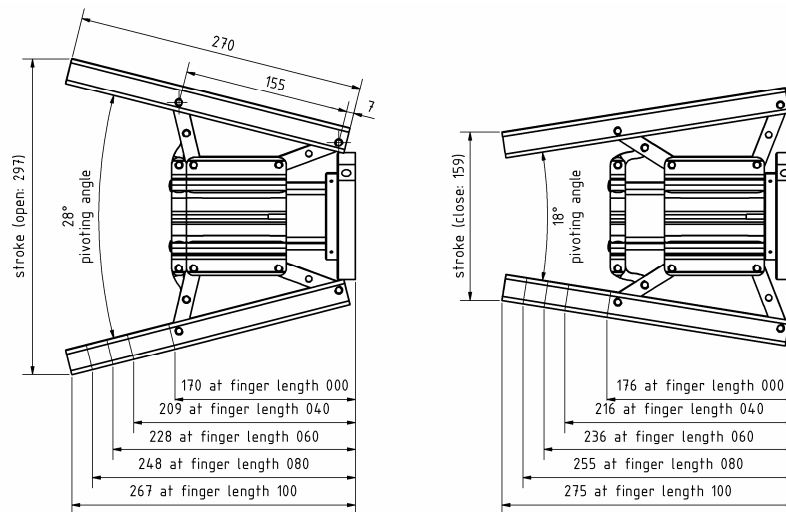

address:
GMG – Gesellschaft für modulare
Greifersysteme mbH
Rödingerweg 8H
D-59494 Soest
Germany

phone:
+49 (0)2921 – 4062
fax:
+49 (0)2921 - 4042

e-mail:
info@gmg-system.com
homepage:
http://www.gmg-system.com



A06

Force- and Gripping-Width-Diagram

Finger Movement A

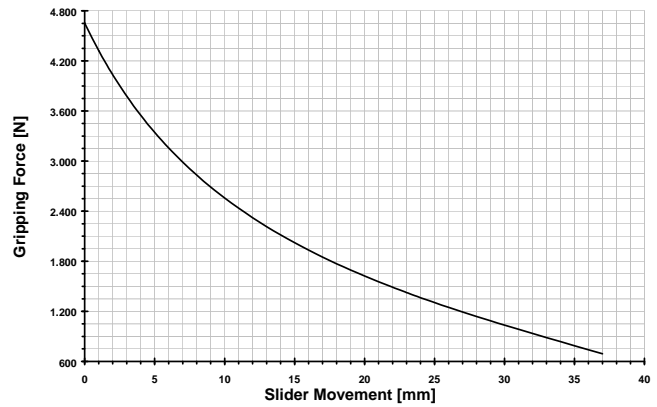
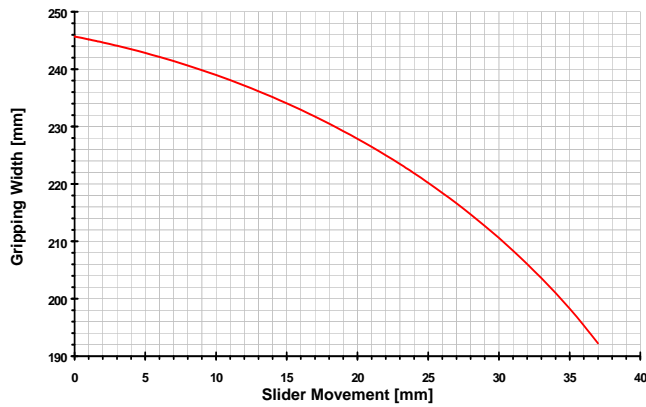

Finger Movement B

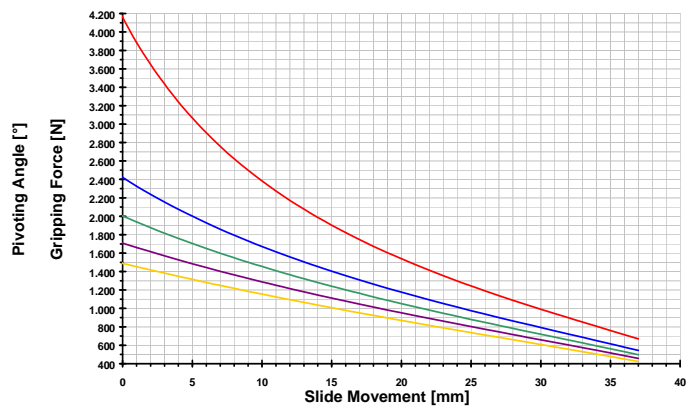
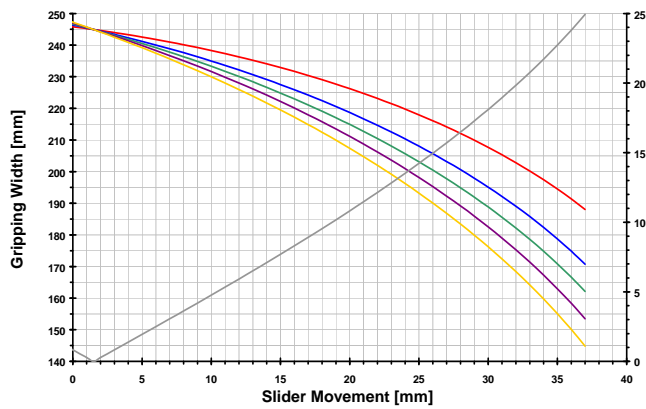

Finger Movement C

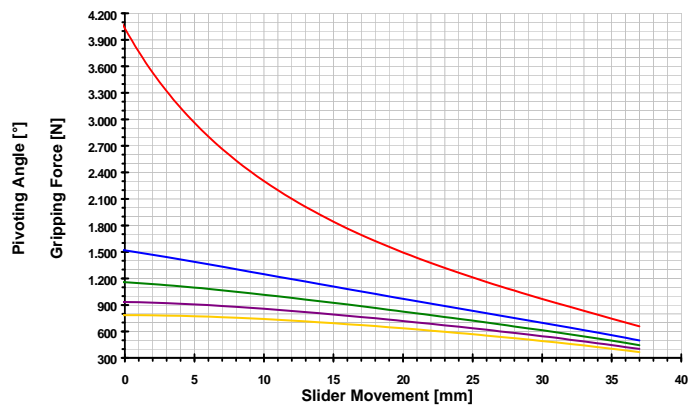
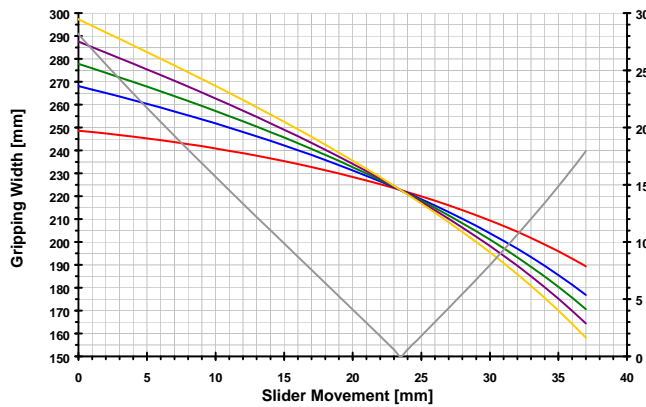

— 0 mm — 40 mm — 60 mm — 80 mm — 100 mm — Pivoting Angle



address:
GMG – Gesellschaft für modulare
Greifersysteme mbH
Rodingerweg 8H
D-59494 Soest
Germany

phone:
+49 (0)2921 – 4062
fax:
+49 (0)2921 - 4042

e-mail:
info@gmg-system.com
homepage:
<http://www.gmg-system.com>



A06

Finger Position Referring to Grippers Flange

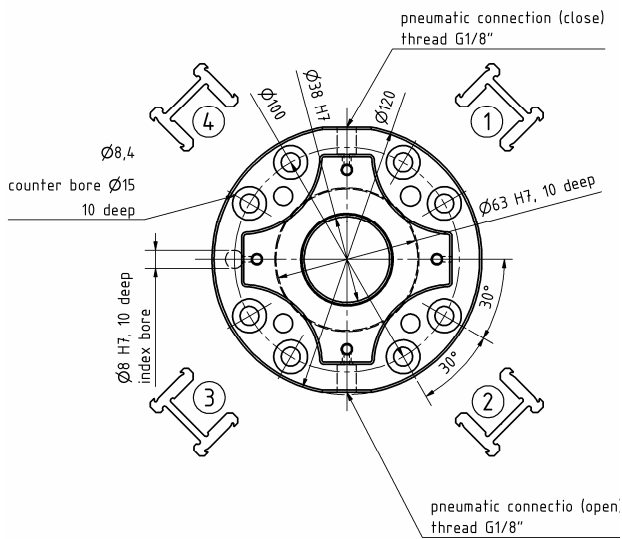

Front View

Standard – Bore - Plan

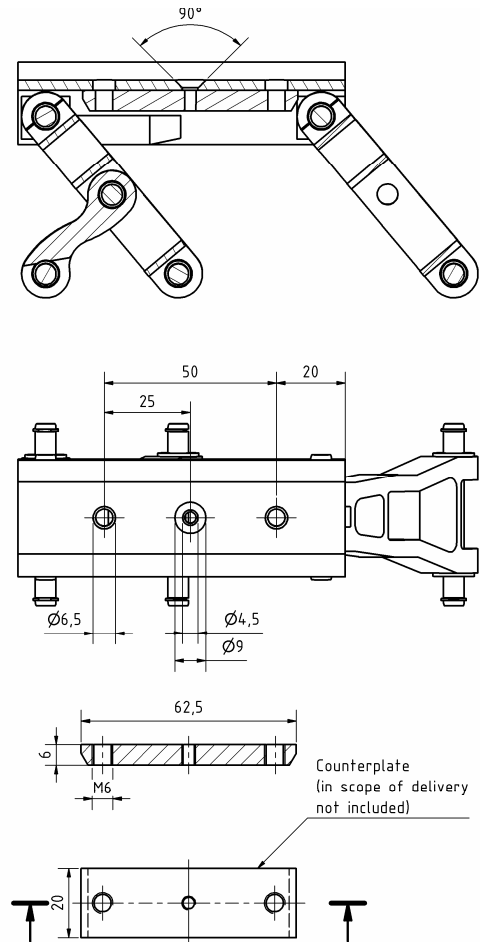

Order Number Counter Plate:
1007-A106-GP06

Only for Finger Length F = 0mm

Finger Quantity	Position				Ident.
	1	2	3	4	
2		X		X	200
	X		X		201
3	X	X		X	300
	X	X	X		301
		X	X	X	302
	X		X	X	303
4	X	X	X	X	400

Standard Style



address:
GMG – Gesellschaft für modulare Greifersysteme mbH
Rodingerweg 8H
D-59494 Soest
Germany

phone:
+49 (0)2921 – 4062
fax:
+49 (0)2921 - 4042

e-mail:
info@gmg-system.com
homepage:
<http://www.gmg-system.com>



Order Number

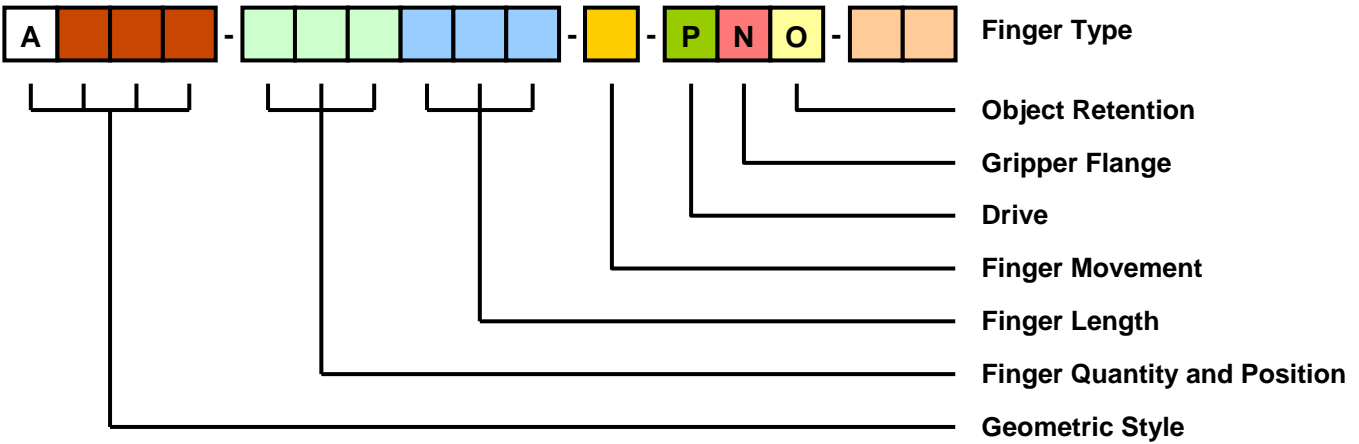

Geometric Style

View "Quantity and Position of Fingers"

Finger Quantity and Position

View table on previous page

Finger Length		
	Length (F)	
Standard	0 mm	000
	40 mm	040
	60 mm	060
	80 mm	080
	100 mm	100
Special Length		Declaration in mm

Finger Movement	
	Ident.
parallel open	A
parallel close	
parallel open	B
swiveling close	
swiveling open	C
swiveling close	
Combination of Finger Movement Styles*	K

* on request

Drive	
	Ident.
Pneumatic	P

Gripper Flange	
	Ident.
Normal	N

Finger Type	
	Ident.
Without Bore	00
With Bore	01

Object Retention at Blackout	
	Ident.
Without Object Retention	O



address:
GMG – Gesellschaft für modulare Greifersysteme mbH
 Rödingerweg 8H
 D-59494 Soest
 Germany

phone:
 +49 (0)2921 – 4062
fax:
 +49 (0)2921 - 4042

e-mail:
 info@gmg-system.com
homepage:
 http://www.gmg-system.com